

Description:

DX-CZ series Celoscreen Sun Louvers are made up of 0.6mm thick aluminum panel, roll formed, in “Z” shape, consisting of two vertical face and one bevelled face. Vertical height is 132mm, 95mm or 70mm. The surface of the panel can be PVDF spraying, powder coating or pre-painted. According to different space, installed the brackets and DX-CZ sun louvers panel. The two panel’s vertical face can be overlapped, it has excellence function of sun control and waterproof. It is suitable for the area with high demand on sun control and waterproof.

Structure& Installation :

DX-CZ series Celoscreen Sun Louvers are “hook” system, using special aluminum extrusion brackets, fixed to the main carrier (square tube, steel angle or steel groove ect.) by M5 screw. Each brackets are installed independently, the DX-CZ sun louvers panels are hooked into the brackets. The systems are detachable, firmly fixed structure, install and maintain easily.

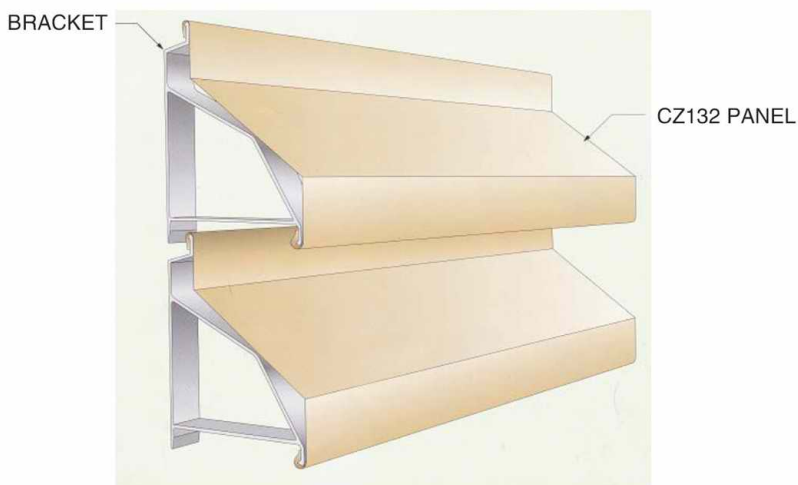

ISOMETRIC DETAILS

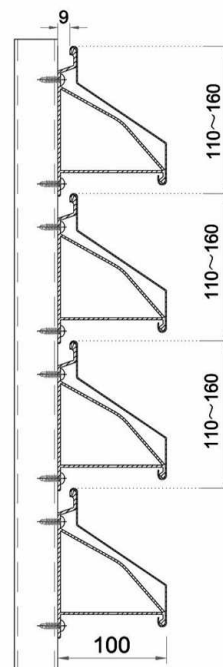

CZ132-SIDE VIEW

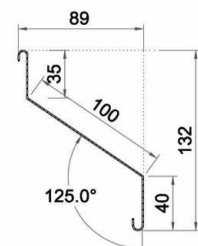

CZ132-PRODUCT DETAILS

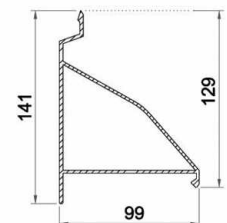

CZ132-BRACKET DETAILS

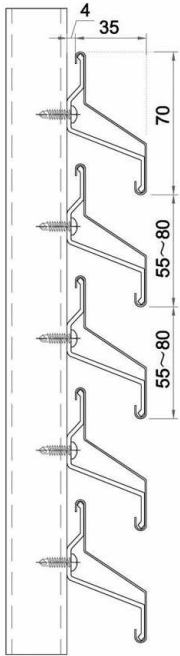

CZ70-SIDE VIEW

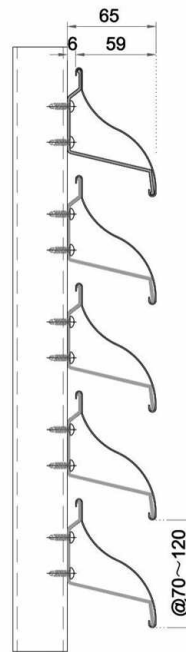
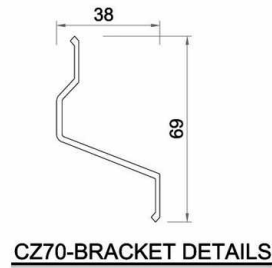
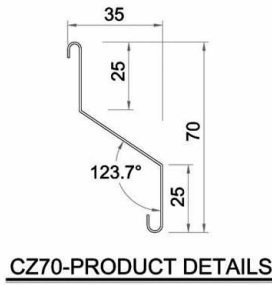

CZ95-SIDE VIEW

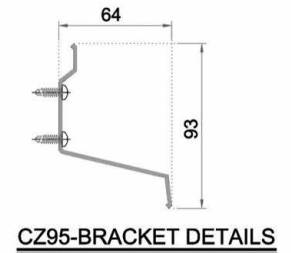
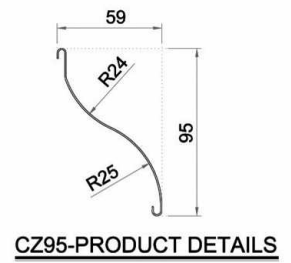

DESCRIPTION		MATERIAL	THICKNESS	RECOMMENDED MAX. LENGTH		MAXIMUM DISTANCE BETWEEN CARRIERS	COLORS
				m	ft		
TYPE			mm			mm	
CARRIER		Aluminum Or G.M.S.	By Other	5.8	13.39	Inside: 900~1200 Outside: 800~1000	Various RAL and woodgrain colors available
BRACKET		Aluminum	2.0				
CZ132/95/70 PANEL	CZ132	Aluminum	0.7	4	13.12		Various RAL and woodgrain colors available
	CZ95	Aluminum	0.6				
	CZ70						

